

# Petroleum, LPG, Steam Hose & Fitting

**Parker**



ENGINEERING YOUR SUCCESS.

# Agenda

- Petroleum Transfer Hose & Fitting
- Composite Hose & Fitting
- Dock Hose & Fitting
- LPG Hose & Fitting
- Steam Hose & Fitting



# Petroleum Transfer Hose & Fitting

## Hose Selector Guide – by application



Series	Trademark	Hose Application / Construction / Selector Guide		Tube	Cover	Size Range (in)	Pressure Range (psi)	Temp Range (°F)	Page No.
7204	MPW-1000®	Hot tar & asphalt	High temp, high pressure	Nitrile	Chloroprene	1/2 - 1	1000	-20/+300/350	230
7216	TRANSLITE®	Tank truck, standard duty	Smooth, black	Nitrile	Nitrile	1 - 6	75-150	-40/+180	215
7216E	TRANSLITE®	Tank truck, standard duty	Smooth, red	Nitrile	Synthetic rubber	1 - 4	150	-35/+180	216
7217	TRANSLITE®	Tank truck, standard duty	Smooth, black	Nitrile	Chloroprene	1 - 4	150	-40/+180	215
7219	EZ FORM™	Multipurpose	Greek corrugated, kink free	Nitrile	Chloroprene	1/2 - 4	75	-20/+200	233
7330		Tank truck, heavy duty		Nitrile	Chloroprene	1-1/4 - 6	250-300	-20/+180	218
7705	GREEN LABEL™	Tank truck, specialty	Corrugated, black	Nitrile	Nitrile/PVC	1 - 4	150-200	-20/+180	221
ES145			Custom Made Hose	Nitrile	Nitrile	1-1/2 - 6	300	-40/+180	228
EW353			Custom Made Hose	Nitrile	Nitrile	10 - 12	65-75	-40/+180	226
SP100			PVC banding coil	n/a	n/a	2 - 6	n/a	n/a	225
XSP100			PVC abrasion coil	n/a	n/a	2 - 6	n/a	n/a	225
SP204	LIGHT-N-BRIGHT™	Tank truck, gravity drop	PVC external helix	Nitrile	Nitrile	2 - 6	75-100	-40/+150	223
SP353	LIGHT-N-BRIGHT™	Tank truck, gravity drop	PVC external helix	Nitrile	Nitrile	2 - 6	150	-40/+150	224
SS107		Tank truck, discharge	Black	Nitrile	Nitrile	1-1/4 - 6	150-250	-40/+180	227
SS107R		Tank truck, discharge	Red	Nitrile	Chloroprene	1-1/2 - 4	150-250	-40/+180	227
SS254		Tank truck, discharge	Black	Nitrile	Nitrile	6 - 8	150	-40/+180	229
SW333		Tank truck, heavy duty	Black	Nitrile	Nitrile	2 - 6	250	-40/+180	217
SW387		Hot tar & asphalt	High temp	Nitrile	Nitrile	1-1/2 - 4	150	-40/+300/350	232
SWC316	PETROMAX™	Tank truck, standard duty	Corrugated, black	Nitrile	Nitrile	1-1/2 - 6	125-150	-40/+180	220
SWC316R	PETROMAX™	Tank truck, standard duty	Corrugated, red	Nitrile	Nitrile	1-1/2 - 6	125-150	-40/+180	220
SWC325	ARCTIC TRANSLITE®	Tank truck, specialty	Low temp	Nitrile	Nitrile	1-1/2 - 6	125-150	-67/+180	222
SWC609	TITANFLEX®	Tank truck, standard duty	Corrugated, black	Nitrile	Nitrile	1-1/2 - 6	125-250	-40/+180	219
SWC609R	TITANFLEX®	Tank truck, standard duty	Corrugated, red	Nitrile	Nitrile	1-1/2 - 6	125-250	-40/+180	219

# Petroleum Transfer Hose & Fitting



Two primary application categories:

- Loading and unloading fuel or chemicals from a tanker to a storage facility
- In-plant transfer

# Petroleum Transfer Hose & Fitting



Two primary application categories:

- Loading and unloading fuel or chemicals from a tanker to a storage facility
- In-plant transfer

# Petroleum Transfer Hose & Fitting



Loading and unloading from a tanker:

- Generally coupled with Cam & Groove couplings for ease of connection
- Hose is stored in a tube on the side of the tanker
- Flexibility, abrasion resistance, and weight are key to the end user

# Petroleum Transfer Hose & Fitting



## In-Plant Transfer :

- Generally coupled with Cam & Groove couplings for ease of connection
- Hose may be used as a permanent connection or as a temporary connector for transfer of fluids

# Petroleum Transfer Hose & Fitting



## Tank Truck Hose :

- Most Tank Truck hose is hard wall (has a helix wire)
- The helix wire prevents collapse during suction or if the hose is kinked or smashed
- The helix wire is generally grounded to the coupling to provide electrical continuity



# Petroleum Transfer Hose & Fitting

The term Hardwall means:



- The hose has a high abrasion (hard) cover
  - The hose has a helix wire for vacuum service and collapse resistance
  - The hose has a high working pressure due to a large amount of reinforcement that makes the hose stiff
  - The hose has an extra thick cover for abrasion resistance.
- 
- The hose has a helix wire for vacuum and collapse resistance

# Petroleum Transfer Hose & Fitting

## TRANSLITE®

### Tank Truck Hose

Series 7216 (Black) and Series 7217 (Red)



Medium Duty(W.P 150PSI)  
Flexible  
Suction & Discharge  
Most popular

## LIGHT-N-BRIGHT™

### Corrugated Tank Truck Hose

External PVC Helix

Series SP353



Medium Duty(W.P 150PSI)  
Flexible  
Suction & Discharge  
Light Weight and PVC Helix

## Heavy Duty Tank Truck Hose

Series 7330



Heavy Duty(W.P 300PSI)  
Flexible  
Suction & Discharge  
Popular



# Petroleum Transfer Hose & Fitting



## TRANSLITE® Tank Truck Hose

Series 7216 (Black) and Series 7217 (Red)

Series 7216/7217 is a suction and discharge hose designed to handle oil and refined fuels such as biodiesel (to B20 in dedicated service), diesel, ethanol and gasoline. The hose construction incorporates a wire helix that provides full suction capability, kink resistance, and a path to conduct a static electrical charge to ground. The cover is resistant to abrasion, oil and weathering. Series 7216/7217 is available in 200-foot continuous lengths.

**NOTE:** Refer to the table on pages 213-214 for fuel compatibility and service conditions.

<b>Tube:</b>	Black nitrile
<b>Reinforcement:</b>	Multiple textile plies with wire helix
<b>Cover:</b>	<b>7216:</b> Black nitrile; wrapped finish <b>7217:</b> Red chloroprene; wrapped finish
<b>Temp. Range:</b>	-40°F to +180°F (-40°C to +82°C)
<b>Brand Method:</b>	<b>7216:</b> Black text on orange stripe <b>7217:</b> Red text on white stripe
<b>Brand Example:</b>	<b>7216:</b> PARKER SERIES 7216/SW309 TRANSLITE® TANK TRUCK HOSE XXX PSI MAX WP MADE IN USA (LOT #) <b>7217:</b> PARKER SERIES 7217 TRANSLITE® TANK TRUCK HOSE 150 PSI MAX WP MADE IN USA (LOT #)
<b>Design Factor:</b>	4:1
<b>Industry Standards:</b>	None applicable
<b>Applications:</b>	<ul style="list-style-type: none"> <li>• Biodiesel (to B20 in dedicated service), diesel, ethanol, gasoline, oil</li> <li>• In-plant and storage tank transfer</li> <li>• Delivery, transport</li> </ul>
<b>Vacuum:</b>	Full
<b>Compare to:</b>	Boston Puma; Gates Longhorn; Veyance Plicord Flexwing
<b>Packaging:</b>	Coils

Series 7216 (Black) and Series 7217 (Red)

Part Number 7216 or 7217	ID (in)	ID (mm)	Reinf Plies	OD (in)	OD (mm)	Approx Wt (lbs/ft)	Approx Wt (kg/ft)	Min Bend Rad (in)	Min Bend Rad (mm)	Max Rec WP (psi)	Max Rec WP (bar)	Perm Cplg Rec *	Std Pack Qty (ft)
-1002	1	25.4	2	1.364	34.6	0.42	0.19	2.0	50.8	150	10.3	*	100
-1252	1-1/4	31.8	2	1.670	42.4	0.59	0.27	3.0	76.2	150	10.3	*	100
-1502	1-1/2	38.1	2	1.968	50.0	0.83	0.38	4.0	101.6	150	10.3	RST	100
-2002	2	50.8	2	2.520	64.0	1.14	0.52	6.0	152.4	150	10.3	RE, RST, TM	100
-2502	2-1/2	63.5	2	3.028	76.9	1.43	0.65	9.0	228.6	150	10.3	*	100
-3002	3	76.2	2	3.543	90.0	1.83	0.83	12.0	304.8	150	10.3	RE, RST, TM	100
-4002	4	101.6	2	4.656	118.3	2.97	1.35	16.0	406.4	150	10.3	HAPS	100
-5004***	5	127.0	4	5.787	147.0	4.46	2.02	39.0	990.6	150	10.3	*	100
-6004***	6	152.4	4	6.811	173.0	5.79	2.63	48.0	1219.2	150	10.3	*	100
-8004***	8	203.2	4	8.976	228.0	9.42	4.27	72.0	1828.8	75	5.2	*	50



# Petroleum Transfer Hose & Fitting

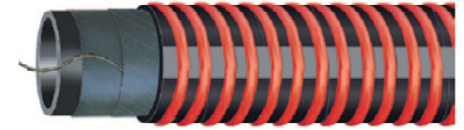

## LIGHT-N-BRIGHT™ Corrugated Tank Truck Hose External PVC Helix Series SP353

Series SP353 is a flexible, lightweight drop hose designed to handle oil and refined fuels such as biodiesel (to B100 in dedicated service), diesel, ethanol and gasoline in gravity flow, higher pressure pump-off, or suction applications. The lightweight hose construction incorporates a static wire as a path to conduct an electrical charge to ground, and the cover features an external PVC helix for full suction capability, flexibility and superior abrasion, crush and kink resistance. Series SP100 banding coils are recommended for installation of couplings. Series XSP100 abrasion coils are available for maximum abrasion resistance along the entire length of the hose.

**NOTE:** Refer to the table on pages 213-214 for fuel compatibility and service conditions.

<b>Tube:</b>	Black nitrile
<b>Reinforcement:</b>	Multiple textile plies with static wire
<b>Cover:</b>	Black nitrile with external red PVC helix
<b>Temp. Range:</b>	-40°F to +150°F (-40°C to +65°C)
<b>Brand Method:</b>	Solid gray stripe
<b>Brand Example:</b>	Not branded
<b>Design Factor:</b>	4:1
<b>Industry Standards:</b>	None applicable
<b>Applications:</b>	<ul style="list-style-type: none"> <li>• Biodiesel (to B100 in dedicated service), diesel, ethanol, gasoline, oil</li> <li>• In-plant and storage tank transfer; transport, delivery</li> <li>• Drop/gravity flow, pump-off service</li> </ul>
<b>Vacuum:</b>	Full
<b>Packaging:</b>	Coils

Part Number	ID (in)	ID (mm)	Reinf Plies	OD (in)	OD (mm)	Approx Wt (lbs/ft)	Approx Wt (kg/ft)	Min Bend Rad (in)	Min Bend Rad (mm)	Max Rec WP (psi)	Max Rec WP (bar)	Std Pack Qty (ft)
SP353-2000	2	50.8	2	3.000	76.2	1.25	0.57	6.0	152.4	150	10.3	100
SP353-3000	3	76.2	2	4.000	101.6	1.78	0.81	8.0	203.2	150	10.3	100
SP353-4000	4	101.6	2	5.000	127.0	2.32	1.05	10.0	254.0	150	10.3	100
SP353-6000	6	152.4	2	7.000	177.8	3.49	1.58	24.0	609.6	150	10.3	100

# Petroleum Transfer Hose & Fitting



Series 7330 is a heavy duty, high pressure suction and discharge hose designed to handle oil and refined fuels such as biodiesel (to B100 in dedicated service), diesel, ethanol and gasoline. The elevated working pressure is suitable for bulk loading and unloading. The hose construction incorporates a wire helix that provides full suction capability, kink resistance, and a path to conduct a static electrical charge to ground. The cover is resistant to abrasion, oil and weathering. Series 7330 is available in 200-foot continuous lengths.

**NOTE:** Refer to the table on pages 213-214 for fuel compatibility and service conditions.

**Tube:** Black nitrile  
**Reinforcement:** Multiple textile plies with helix wire  
**Cover:** Black chloroprene, wrapped finish  
**Temp. Range:** -20°F to +180°F (-29°C to +82°C)  
**Brand Method:** Red text on white stripe  
**Brand Example:** PARKER SERIES 7330 HD TANK TRUCK 300 PSI MAX WP MADE IN USA (LOT #)  
**Design Factor:** 4:1  
**Industry Standards:** None applicable  
**Applications:**

- Biodiesel (to B100 in dedicated service), diesel, ethanol, gasoline, oil
- High pressure in-plant and storage tank transfer
- High pressure bulk loading/unloading; delivery, transport

**Vacuum:** Full  
**Compare to:** Veyance Plicord Super Black Flexwing  
**Packaging:** Coils

Part Number	ID (in)	ID (mm)	Reinf Plies	OD (in)	OD (mm)	Approx Wt (lbs/ft)	Approx Wt (kg/ft)	Min Bend Rad (in)	Min Bend Rad (mm)	Max Rec WP (psi)	Max Rec WP (bar)	Perm Cplg Rec *	Std Pack Qty (ft)
7330-1250	1-1/4	31.8	2	1.686	42.8	0.71	0.32	6.0	152.4	300	20.7	*	100
7330-1500	1-1/2	38.0	2	1.976	50.2	1.00	0.45	8.0	203.2	300	20.7	*	100
7330-2000	2	50.8	4	2.622	66.6	1.57	0.71	8.0	203.2	300	20.7	*	100
7330-2000200	2	50.8	4	2.622	66.6	1.57	0.71	8.0	203.2	300	20.7	*	200
7330-3000	3	76.2	4	3.654	92.8	2.41	1.09	15.0	381.0	300	20.7	TM	100
7330-3000200	3	76.2	4	3.654	92.8	2.41	1.09	15.0	381.0	300	20.7	TM	200
7330-4000	4	101.6	4	4.840	123.0	4.12	1.87	20.0	508.0	300	20.7	*	100
7330-4000200	4	101.6	4	4.840	123.0	4.12	1.87	20.0	508.0	300	20.7	*	200
7330-6000	6	152.4	6	6.968	177.0	6.99	3.17	36.0	914.4	300	20.7	*	100

# Petroleum Transfer Hose & Fitting

## Hose Fitting

### Cam and Groove

#### Styles offered:

- Dixon® type C couplers
- EZ Boss-Lock™ type C couplers
- Dixon® type E adapters
- global type C couplers
- global type E adapters

#### Materials:

- 356T6 aluminum
- brass
- 316 stainless steel
- unplated ductile iron

#### Sizes:

- 1", 1¼", 1½", 2", 3", 4", 6"



# Petroleum Transfer Hose & Fitting

## Hose Fitting



King Crimp Style ANSI 150#,300#

Size : 2" ~6"

Material : Steel, S/S

# Petroleum Transfer Hose & Fitting

## Hose Fitting

### **Double Bolt Clamps** (Size : 1"~ 3")

#### Features:

- inner surface has dual gripping ridges
- bolt lugs are reinforced to prevent bending out of alignment
- Torque values for clamps are based on dry bolts.
- The use of lubricant on bolts will adversely effect clamp performance.
- measure hose OD accurately before ordering clamps





# Petroleum Transfer Hose & Fitting

## Hose Fitting

### **Double Bolt Clamps** (Size : 4" ~ 15")

#### Features:

- inner surface has dual gripping ridges
- bolt lugs are reinforced to prevent bending out of alignment
- Torque values for clamps are based on dry bolts.
- The use of lubricant on bolts will adversely effect clamp performance.
- measure hose OD accurately before ordering clamps



# Petroleum Transfer Hose & Fitting

## Hose Protect Accessories



Cover colors available:

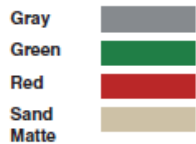

### Orange PVC Banding Coil / PVC Abrasion Coil

Series SP100/XSP100

Series SP100 is a rugged PVC coil that threads onto a complementary hose end to create a uniform banding area for coupling attachment. The coil fills the gaps between the loops of the outer PVC helix, providing an area for securing the banding clamp or ferrule. Series XSP100 threads onto the entire length of a complementary hose to protect it from abrasion and scuffs, helping to extend hose life in highly abrasive areas. Series SP100 and XSP100 are applied to Parker SP204, SP330, SP353 and SP483 hoses.

#### XSP100 (ft)

Part Number	Hose ID (in)	Hose ID (mm)	Approx Wt (lbs/ft)	Approx Wt (kg/ft)	Ft.
XSP100-2000	2	50.8	0.19	0.09	100
XSP100-3000	3	76.2	0.33	0.15	100
XSP100-4000	4	101.6	0.46	0.21	100
XSP100-6000	6	152.4	1.02	0.46	100

# Composite Hose & Fitting



# Composite Hose & Fitting

## Petroleum Transfer Hose

Series 2100



**Inner Wire:** Galvanized steel (G)  
**Inner Liner:** Polypropylene fabric  
**Hose Wall:** Multiple layers of fabric/film/tubes  
**Cover:** Blue PVC-covered polyester  
**Outer Wire:** Galvanized steel (G)  
**Temp Range:** -40°F to +212°F (-40°C to +100°C)  
**Brand Method:** Black text on gold stripe  
**Brand Example:** PARKER SERIES 2100 PETROLEUM TRANSFER HOSE  
 XXX PSI MAX WP MADE IN USA

**Design Factor:** 4:1  
**Industry Standards:** American Bureau of Shipping (ABS) Certificate of Design Assessment  
 2009 Steel Vessels Rules

**Applications:** Marine, plant processing, rail car, ship-to-shore, tank truck  
**NOTE:** Not for dry material service.

**Vacuum:** Full  
**Compare to:** Apollo 100P; Dantec Danoil 7 GG; Peraflex GGP Hydrocarbon; Tift 901  
 Fuelmaster; Uni-Chem Uni-Oil GG; Wilcox 1091/1151 GG

Part Number	ID (in)	ID (mm)	Approx Wt (lbs/ft)	Min Bend Rad (in)	Max Rec WP (psi)	Max Lg (ft)
2100GG-1000	1	25.4	0.8	5.0	250	75
2100GG-1500	1-1/2	38.1	1.0	6.0	250	75
2100GG-2000	2	50.8	1.2	6.5	250	75
2100GG-2500	2-1/2	63.5	1.6	8.0	250	75
2100GG-3000	3	76.2	2.0	9.5	250	70
2100GG-4000	4	101.6	4.4	16.0	250	70
2100GG-6000	6	152.4	7.0	20.0	250	65
2100GG-8000	8	203.2	10.0	29.0	250	65
2100GG-10000	10	254.0	23.0	40.0	150	50

**Standard Wire:** G (Galvanized) inner and outer  
**Available Wire Options:** See table below  
**Coupling Rec:** Permanently attached one-piece male pipe or flanged ends; cam and groove. [Refer to page 387](#) for standard factory coupling options.  
**Assemblies:** Per customer requirement; hydrostatically tested to 150% of the rated working pressure. Contact Parker.

### Available Component Materials

Component	Description	Alpha Designation in Hose Part Number
Inner Wire	Galvanized Steel	G
Outer Wire	Galvanized Steel	G
Inner Liner	Polypropylene	n/a (Standard)
	Polytetrafluoroethylene (PTFE)	#
Couplings	Carbon Steel	-
	Stainless Steel	-

# Composite Hose & Fitting

## Bottom Loading Hose

Series 4500



<b>Inner Wire:</b>	Galvanized steel (G)
<b>Inner Liner:</b>	Polypropylene fabric
<b>Hose Wall:</b>	Multiple layers of fabric/film/tubes
<b>Cover:</b>	Blue PVC coated polyester
<b>Outer Wire:</b>	Galvanized steel (G)
<b>Temp Range:</b>	-40°F to +212°F (-40°C to +100°C)
<b>Brand Method:</b>	Black text on gold stripe
<b>Brand Example:</b>	PARKER SERIES 4500 BOTTOM LOADING HOSE 200 PSI MAX WP MADE IN USA
<b>Design Factor:</b>	4:1
<b>Industry Standards:</b>	None applicable
<b>Applications:</b>	Hose loading arms in bottom loading applications at bulk distributing and refining facilities <b>NOTE:</b> Not for dry material service.
<b>Vacuum:</b>	Full
<b>Compare To:</b>	Peraflex BL-GGP Bottom Loading; Tift 901/401 Bottom Loading; Uni-Chem Uni-BL; Wilcox 4124SS/4121SG

Part Number	ID (in)	ID (mm)	Approx Wt (lbs/ft)	Min Bend Rad (in)	Max Rec WP (psi)	Max Lg (ft)
4500GG-3000	3	76.2	2.0	9.5	200	70
4500GG-4000	4	101.6	4.4	16.0	200	70

<b>Standard Wire:</b>	G (Galvanized) inner and outer
<b>Available Wire Options:</b>	See table below
<b>Coupling Rec:</b>	Permanently attached one-piece TTMA (Truck Trailer Manufacturers Association) flanges. Refer to page 387 for standard factory coupling options.
<b>Assemblies:</b>	Per customer requirement; hydrostatically tested to 150% of the rated working pressure. Contact Parker.

### Available Component Materials

Component	Description	Alpha Designation in Hose Part Number
Inner Wire	Galvanized Steel	G
Outer Wire	Galvanized Steel	G
Inner Liner	Polypropylene	n/a (Standard)
Couplings	Carbon Steel	-
	Stainless Steel	-

# Dock Hose & Fitting

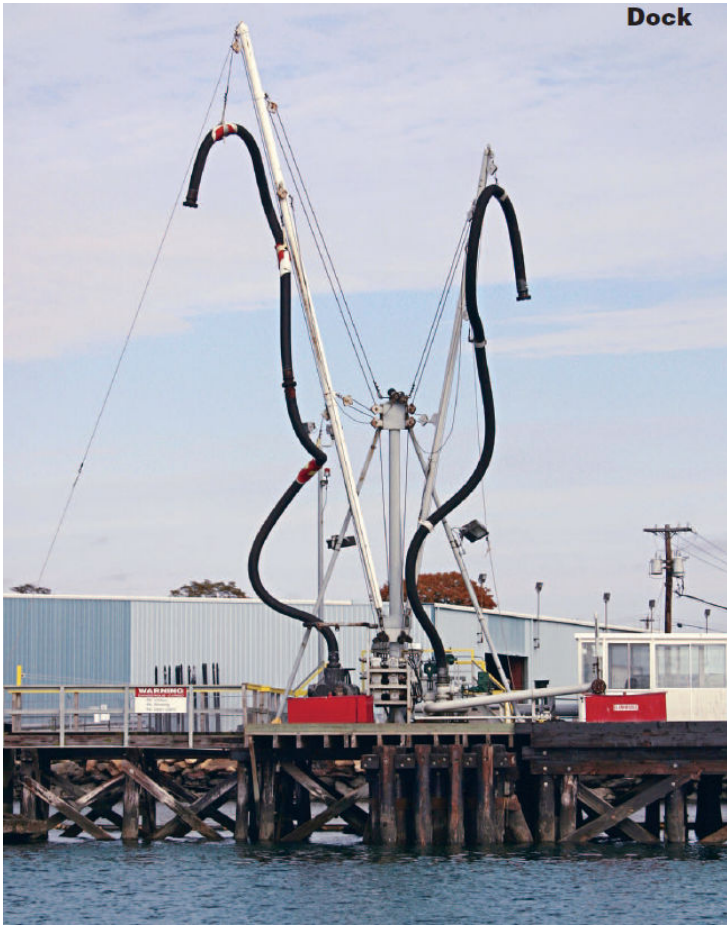

# Dock Hose & Fitting

## Hose Selector Guide – by application

Series	Trademark	Hose Application / Construction / Selector Guide		Tube	Cover	Size Range (in)	Pressure Range (psi)	Temp Range (°F)	Page No.
EW339		Petroleum	50% aromatics	Nitrile	Synthetic rubber	6 - 12	200	-40 / +180	91
EW355		Petroleum	50% aromatics	Nitrile	Synthetic rubber	6 - 12	250	-40 / +180	92
EW399		Petrochemical	100% aromatics	FKM	Synthetic rubber	4 - 10	250	-40 / +180	96
EW460		Molten sulphur		EPDM	EPDM	6 - 10	200	-40 / +300	97
EW499		Hot tar & asphalt		FKM	Synthetic rubber	4 - 10	200	-40 / +350	98
EWC439		Petroleum	50% aromatics, corrugated	Nitrile	Synthetic rubber	4 - 12	225	-40 / +180	93
SW339		Petroleum	50% aromatics	Nitrile	Synthetic rubber	4 - 8	200	-40 / +180	94
SW356		Petroleum	60% aromatics	Nitrile	Synthetic rubber	4 - 8	250-300	-40 / +180	95

**NOTE:** This is a guide only. It is the responsibility of the end user to select and/or test the most appropriate product for the application. Refer to product pages for specific data. Contact Parker for additional information.

# Dock Hose & Fitting

## Heavy Duty Dock Hose – Petroleum Service USCG Series EW339 *Custom Made Hose*



Series EW339 is a heavy duty oil suction and discharge (OS&D)/dock hose for transferring oil between tankers, barges, and storage tanks. The hose construction incorporates a specially formulated tube that resists media to 50% aromatic content. The wire helix provides full suction capability, kink resistance and a path to conduct a static electrical charge to ground. The rugged cover is resistant to abrasion, mild chemicals, oil and weathering. Series EW339 meets all United States Coast Guard (USCG) requirements for dock/OS&D hose.

**NOTES:**

- Other customized versions of this product are available. Contact Parker.
- For corrugated construction, refer to Series EWC339. Contact Parker.
- For smaller diameter hose, refer to Series SW339.

**Tube:** Black nitrile  
**Reinforcement:** Multiple plies of tire cord with wire helix  
**Cover:** Black synthetic rubber; wrapped finish  
**Temp. Range:** -40°F to +180°F (-40°C to +82°C)  
**Brand Method:** Black text on red stripe  
**Brand Example:** PARKER SERIES EW339 NITRILE / OIL SERVICE  
**Design Factor:** 4:1  
**Industry Standards:** USCG  
**Applications:**

- Oil and fuel to 50% aromatic content
- Transfer between barges, storage tanks and marine vessels

**Vacuum:** Full  
**Packaging:** Lengths or coils in bales, crates or slat packs  
**Couplings:** Built-in nipples, male pipe or flanged. Other configurations available. Contact Parker.

Part Number	ID (in)	ID (mm)	Reinf Plies	OD (in)	OD (mm)	Approx Wt (lbs/ft)	Approx Wt (kg/ft)	Min Bend Rad (in)	Min Bend Rad (mm)	Max Rec WP (psi)	Max Rec WP (bar)	Max Lg (ft)
EW339-6000	6	152.4	4	7.125	181.0	8.00	3.63	36.0	914.4	200	13.8	100
EW339-8000	8	203.2	6	9.375	247.7	13.30	6.03	48.0	1219.2	200	13.8	50
EW339-10000	10	254.0	8	11.750	298.5	20.00	9.07	60.0	1524.0	200	13.8	50
EW339-12000	12	304.8	8	13.750	349.3	27.00	12.25	72.0	1828.8	200	13.8	50



# Dock Hose & Fitting

## Heavy Duty Dock Hose – Petroleum Service USCG

Series EW355

*Custom Made Hose*



Series EW355 is a heavy duty oil suction and discharge (OS&D)/dock hose for transferring oil between tankers, barges, and storage tanks. The hose construction incorporates a specially formulated tube that resists media to 50% aromatic content. The wire helix provides full suction capability, kink resistance and a path to conduct a static electrical charge to ground. The rugged cover is resistant to abrasion, mild chemicals, oil and weathering. Series EW355 meets all United States Coast Guard (USCG) requirements for dock/OS&D hose.

**NOTE:** Other customized versions of this product are available. Contact Parker.

- Tube:** Black nitrile  
**Reinforcement:** Multiple plies of tire cord with wire helix  
**Cover:** Black synthetic rubber; wrapped finish  
**Temp. Range:** -40°F to +180°F (-40°C to +82°C)  
**Brand Method:** Black text on red stripe  
**Brand Example:** PARKER SERIES EW355 DOCK HOSE 250 PSI ASSEMBLY - USCG CERTIFIED - USA
- Design Factor:** 4:1  
**Industry Standards:** USCG  
**Applications:**
  - Oil and fuel to 50% aromatic content
  - Transfer between barges, storage tanks and marine vessels
- Vacuum:** Full  
**Packaging:** Lengths or coils in bales, crates or slat packs  
**Couplings:** ANSI 150# carbon steel built-in nipples and fixed x floating flanges. Other lengths and configurations available. Contact Parker.

Assembly Part Number	ID (in)	ID (mm)	Reinf Plies	OD (in)	OD (mm)	Approx Wt (lbs/ea)	Approx Wt (kg/ea)	Min Bend Rad (in)	Min Bend Rad (mm)	Max Rec WP (psi)	Max Rec WP (bar)	Assy Lg (ft)
EW355X6000KAB-300	6	152.4	6	7.250	184.2	300.00	136.10	36.0	914.4	250	17.2	25
EW355X6000KAB-360	6	152.4	6	7.250	184.2	330.00	149.70	36.0	914.4	250	17.2	30
EW355X8000KAB-360	8	203.2	8	9.500	241.3	550.00	249.50	48.0	1219.2	250	17.2	30
EW355X10000KAB-300	10	254.0	8	11.750	298.5	655.00	297.10	60.0	1524.0	250	17.2	25
EW355X12000KAB-240	12	304.8	10	13.875	352.4	785.00	356.10	72.0	1828.8	250	17.2	20



# Dock Hose & Fitting

## Heavy Duty Dock Hose – Petroleum Service USCG Series SW339



Series SW339 is a heavy duty oil suction and discharge (OS&D)/dock hose for transferring oil between tankers, barges, and storage tanks. The hose construction incorporates a specially formulated tube that resists media to 50% aromatic content. The dual wire helix provides full suction capability, kink resistance and a path to conduct a static electrical charge to ground. The rugged cover is resistant to abrasion, mild chemicals, oil and weathering. Series SW339 meets all United States Coast Guard (USCG) requirements for dock/OS&D hose.

**NOTES:**

- For corrugated hose, refer to Series EWC439.
- For larger diameter hose, refer to Series EW339.

**Tube:** Black nitrile  
**Reinforcement:** Multiple plies of tire cord with dual wire helix  
**Cover:** Black synthetic rubber; wrapped finish  
**Temp. Range:** -40°F to +180°F (-40°C to +82°C)  
**Brand Method:** Black text on red stripe  
**Brand Example:** PARKER SERIES SW339 NITRILE/OIL SERVICE 200 PSI WP  
 MADE IN USA  
**Design Factor:** 4:1  
**Industry Standards:** USCG  
**Applications:**

- Oil and fuel to 50% aromatic content
- Transfer between barges, storage tanks and marine vessels

**Vacuum:** Full  
**Packaging:** Coils

Part Number	ID (in)	ID (mm)	Reinf Plies	OD (in)	OD (mm)	Approx Wt (lbs/ft)	Approx Wt (kg/ft)	Min Bend Rad (in)	Min Bend Rad (mm)	Max Rec WP (psi)	Max Rec WP (bar)	Std Pack Qty (ft)
SW339-4000	4	101.6	4	5.188	131.8	5.80	2.63	16.0	406.4	200	14	100
SW339-6000	6	152.4	4	7.250	184.2	9.41	4.27	36.0	914.4	200	14	100
SW339-8000	8	203.2	4	9.250	235.0	12.35	5.60	48.0	1219.2	200	14	100

# Dock Hose & Fitting

## Heavy Duty Dock Hose – Petroleum Service

Series SW356



Series SW356 is a heavy duty oil suction and discharge (OS&D)/dock hose for transferring oil between tankers, barges, and storage tanks. The hose construction incorporates a specially formulated tube that resists media to 60% aromatic content. The wire helix provides full suction capability, kink resistance and a path to conduct a static electrical charge to ground. The rugged cover is resistant to abrasion, mild chemicals, oil and weathering.

<b>Tube:</b>	Black nitrile
<b>Reinforcement:</b>	Multiple plies of tire cord with dual wire helix
<b>Cover:</b>	Black synthetic rubber; wrapped finish
<b>Temp. Range:</b>	-40°F to +180°F (-40°C to +82°C)
<b>Brand Method:</b>	Black text on red stripe
<b>Brand Example:</b>	PARKER SERIES SW356 HEAVY DUTY OS&D HOSE XXX PSI WP MADE IN U.S.A.
<b>Design Factor:</b>	4:1
<b>Industry Standards:</b>	None applicable
<b>Applications:</b>	<ul style="list-style-type: none"> <li>• Oil and fuel to 60% aromatic content</li> <li>• Transfer between barges, storage tanks and marine vessels</li> </ul>
<b>Vacuum:</b>	Full
<b>Packaging:</b>	Coils

Part Number	ID (in)	ID (mm)	Reinf Plies	OD (in)	OD (mm)	Approx Wt (lbs/ft)	Approx Wt (kg/ft)	Min Bend Rad (in)	Min Bend Rad (mm)	Max Rec WP (psi)	Max Rec WP (bar)	Std Pack Qty (ft)
SW356-4000	4	101.6	4	5.250	133.4	6.09	2.76	20.0	508.0	300	20.7	100
SW356-6000	6	152.4	4	7.375	187.3	9.80	4.45	34.0	863.6	300	20.7	100
SW356-8000	8	203.2	4	9.375	238.1	12.69	5.76	46.0	1168.4	250	17.2	100

# Dock Hose & Fitting

## Hose Fitting

### Cam and Groove

#### Styles offered:

- Dixon® type C couplers
- EZ Boss-Lock™ type C couplers
- Dixon® type E adapters
- global type C couplers
- global type E adapters

#### Materials:

- 356T6 aluminum
- brass
- 316 stainless steel
- unplated ductile iron

#### Sizes:

- 1", 1¼", 1½", 2", 3", 4", 6"



# Dock Hose & Fitting

## Hose Fitting



King Crimp Style ANSI 150#,300#

Size : 2" ~6"

Material : Steel, S/S

# Dock Hose & Fitting

## Hose Fitting

### **Double Bolt Clamps** (Size : 1"~ 3")

#### Features:

- inner surface has dual gripping ridges
- bolt lugs are reinforced to prevent bending out of alignment
- Torque values for clamps are based on dry bolts.
- The use of lubricant on bolts will adversely effect clamp performance.
- measure hose OD accurately before ordering clamps



# Dock Hose & Fitting

## Hose Fitting

### **Double Bolt Clamps** (Size : 4" ~ 15")

#### Features:

- inner surface has dual gripping ridges
- bolt lugs are reinforced to prevent bending out of alignment
- Torque values for clamps are based on dry bolts.
- The use of lubricant on bolts will adversely effect clamp performance.
- measure hose OD accurately before ordering clamps







# Dock Hose & Fitting

## Hose Protect Accessories



Cover colors available:

Gray	
Green	
Red	
Sand Matte	

### Orange PVC Banding Coil / PVC Abrasion Coil

Series SP100 / XSP100

Series SP100 is a rugged PVC coil that threads onto a complementary hose end to create a uniform banding area for coupling attachment. The coil fills the gaps between the loops of the outer PVC helix, providing an area for securing the banding clamp or ferrule. Series XSP100 threads onto the entire length of a complementary hose to protect it from abrasion and scuffs, helping to extend hose life in highly abrasive areas. Series SP100 and XSP100 are applied to Parker SP204, SP330, SP353 and SP483 hoses.

#### XSP100 (ft)

Part Number	Hose ID (in)	Hose ID (mm)	Approx Wt (lbs/ft)	Approx Wt (kg/ft)	Ft.
XSP100-2000	2	50.8	0.19	0.09	100
XSP100-3000	3	76.2	0.33	0.15	100
XSP100-4000	4	101.6	0.46	0.21	100
XSP100-6000	6	152.4	1.02	0.46	100



## LPG Hose & Fitting

# LPG Hose (Liquid Petroleum Gas)

# LPG Hose & Fitting

## **What is LPG or LP Gas?**

LPG or LP Gas is the abbreviation of Liquefied Petroleum Gas. This group of products includes saturated hydrocarbons - Propane (C<sub>3</sub>H<sub>8</sub>) and Butane (C<sub>4</sub>H<sub>10</sub>), which can be stored/transported separately or as a mixture. They exist as gases at normal room temperature and atmospheric pressure.

## **Why is it called Liquefied Petroleum Gas?**

This is because these gases liquefy under moderate pressure, readily vaporizing upon release of pressure. It is this property that permits transportation of and storage of LP Gas in concentrated liquid form.

## **Where does LPG come from?**

LPG comes from two sources. It can be obtained from the refining of crude oil. When produced this way it is generally in pressurized form. LPG is also extracted from natural gas or crude oil streams coming from underground reservoirs. 60% of LPG in the world today is produced this way whereas 40% of LPG is extracted from refining of crude oil.

# LPG Hose & Fitting

## Application

- Propane, also called LPG (Liquefied petroleum gas), is most commonly used as a fuel.
- This fuel is generally transferred as a pressurized liquid (LPG).
- The fuel is generally passed through a regulator and burned as a low pressure vapor.
- Propane is considered a hazardous material and the hoses used for transfer of propane are specifically designed for this application.

# LPG Hose & Fitting

## Application

- Because LPG is transferred as a liquid (compressed gas), the hose cover is perforated to allow the escape of propane vapor due to permeation.
- If the hose is wet or laying in water, it is actually possible to see this permeation coming out of the perforations in the hose cover.
- This is often wrongly assumed to be leakage. Actual LPG leakage will usually frost on the surface of the hose.
- The UL standard has a maximum allowable rate of permeation that the hose must meet. The IHP products easily meet this requirement.

# LPG Hose & Fitting

## Two Primary Application Categories

- Low pressure vapor transfer. This is generally hoses smaller than  $\frac{3}{4}$ " feeding a cooker, engine, or heater.
- High pressure ( $\leq 350$  psi) liquid transfer. The pressure and temperature combined must be adequate to compress the vapor into liquid. Higher heat requires higher pressure to compress the gas to liquid. This application is usually hoses  $\frac{3}{4}$ " and larger.

# LPG Hose & Fitting

## There are Two Standard for this hose

- UL 569 – This standard addresses assemblies used to connect the propane source to the appliance using the gas (such as gas grills, fish cookers, heaters, etc...). This standard addresses both hose and assembly requirements. The assembler must be UL listed. Most hoses built to this standard are small ID hoses ( $\leq 1/2$ " ).
- UL 21 – This standard applies to hoses used for the bulk transfer of propane (LPG). This standard does not address assembly certification, only hose certification. The most popular sizes are 1" I.D. for Bobtail delivery and 2" I.D. for Bulk Tank Truck loading and unloading.

# LPG Hose & Fitting

## Hose Selector Guide – by application

Series	Trademark	Hose Application / Construction / Selector Guide		Tube	Cover	Size Range (in)	Pressure Range (psi)	Temp Range (°F)	Page No.
7122		Farm, light industrial	Non-UL applications	Nitrile	Chloroprene	3/8	350	-20 / +160	<a href="#">210</a>
7132		Delivery, industrial		Nitrile	Chloroprene	3/16 - 1	350	-40 / +180	<a href="#">195</a>
7132XTC	X-TREME™	Delivery, industrial	Low temperature (-65°F)	Nitrile	Chloroprene	1/4 - 1	350	-65 / +180	<a href="#">198</a>
7170		Gas grills, appliances		Nitrile	Chloroprene	1/4 - 3/8	350	-40 / +180	<a href="#">209</a>
7231		Bulk loading/unloading, short connectors	Extremely durable	Nitrile	Chloroprene	1 - 2	350	-40 / +180	<a href="#">202</a>
7232		Bulk loading/unloading, short connectors		Nitrile	Chloroprene	1-1/4 - 2	350	-40 / +180	<a href="#">200</a>
7233		Fork lifts, utility vehicles		Nitrile	Chloroprene	5/16	350	-40 / +180	<a href="#">206</a>
7243		Fork lifts, utility vehicles		Nitrile	Textile	1/4 - 1/2	350	-40 / +180	<a href="#">207</a>
SS106		Bulk loading/unloading	Non-UL applications	Nitrile	Nitrile	1-1/4 - 4	350	-40 / +180	<a href="#">204</a>

# LPG Hose & Fitting



**7132**

**Sizes: 3/16" - 1"**  
**Used for delivery and transfer applications**



**7232**

**Sizes: 1 1/4" - 2"**  
**Used for Bulk Plant Delivery**



**7231**

**Sizes: 3/4" - 2"**  
**Used where a premium product for LPG transfer is required**



**SS106**

**Sizes: 3/4" - 2"**  
**Used for Bulk Plant Loading/Unloading**



# LPG Hose & Fitting

## LP Gas Hose UL21, CGA Type I Series 7132



Series 7132 is a flexible, lightweight liquefied petroleum gas (LPG)/propane delivery and transfer hose. The hose meets all Underwriters Laboratories (UL21) and Canadian Gas Association (CGA Type I) requirements. The construction incorporates multiple textile plies of reinforcement for flexibility and kink resistance. The perforated cover is resistant to mild chemicals, oil and ozone. Series 7132 is available in long lengths on reels, long cut lengths and factory-tested assemblies from stock in popular configurations.

**NOTE:** Refer to the Safety and Technical section of this catalog for safety, handling and use information.

**Series 7132 and DOT:** LPG hose assemblies installed on on-road vehicles must meet Department of Transportation (DOT) requirements. Factory assemblies (3/4" and larger) are pressure tested, one of the fittings is etched with a unique DOT certification number, and a document incorporating the identical certification number accompanies each assembly. Metal DOT identification bands are also available/attached for an additional charge at customer request. Contact Parker.

**Series 7132 and Natural Gas:** The molecules of natural gas are small, enhancing their ability to permeate through standard rubber hose constructions. The permeation process is more rapid as the working pressure increases, and natural gas accumulates with potentially dangerous consequences. Series 7132 may be used for natural gas service, but ONLY under ALL of the following conditions:

- The application must be in a well-ventilated environment: Outdoors, or indoors with significant continuous air movement.
- Series 7132 is not to replace fixed/rigid pipe where that material is more appropriate due to reduced permeation and overall strength and durability. Use rigid pipe, non-permeable tubing or hose with barrier constructions to convey natural gas whenever possible.

**Series 7132 and Compressed Natural Gas (CNG):** Series 7132 is not for use in any CNG application, including fuel dispensing, on-board vehicle fuel lines, or fuel transfer.

**Series 7132 and Anhydrous Ammonia (NH<sub>3</sub>):** Series 7132 is not for use with anhydrous ammonia.

**Tube:** Black nitrile  
**Reinforcement:** Multiple textile plies  
**Cover:** Black chloroprene; perforated smooth finish  
**Temp. Range:** -40°F to +180°F (-40°C to +82°C) (The hose construction is capable of this rating, but LP Gas should NEVER be conveyed over 140°F/60°C)  
**Brand Method:** Impression  
**Brand Example:** PARKER SERIES 7132 (ID) CSA® CAN 1-8.1 CGA TYPE I CAUTION - LP GAS HOSE MH6737 C UR® US ISSUE NO. XXXXXX 350 PSI MAX WP MADE IN USA (DATE CODE)

**Design Factor:** 5:1  
**Industry Standards:** UL21; CAN/CGA-8.1-M86 Type I; optional DOT factory hose assembly testing and marking also available for sizes smaller than 3/4". Contact Parker.

**Applications:**

- LP gas/propane
- Cookers, grills, heaters, weed burners; delivery, transfer
- Agriculture, commercial and residential heating, construction, general industrial

**Vacuum:** Not recommended  
**Compare to:** Boston Blackline (LPG); Gates LP350; Thermoid Type 75  
**Packaging:** Cartons, coils, reels ("E" suffix in part number indicates UPS-shippable reel under 80 pounds)

(Continued on the following page)

## Series 7132 – LP Gas Hose, UL21, CGA Type I (Continued)

Part Number	ID (in)	ID (mm)	Reinf Plies	OD (in)	OD (mm)	Approx Wt (lbs/ft)	Approx Wt (kg/ft)	Min Bend Rad (in)	Min Bend Rad (mm)	Max Rec WP (psi)	Max Rec WP (bar)	Perm Cplg Rec *	Std Pack Qty (ft)
7132-19352	3/16	4.8	2	0.510	13.0	0.11	0.05	2.0	50.8	350	24.1	*	800
7132-25354	1/4	6.4	4	0.610	15.5	0.15	0.07	2.5	63.5	350	24.1	7661	750
7132-25354E	1/4	6.4	4	0.610	15.5	0.15	0.07	2.5	63.5	350	24.1	7661	350
7132-38354	3/8	9.5	4	0.760	19.1	0.22	0.10	3.5	88.9	350	24.1	HY	600
7132-38354E	3/8	9.5	4	0.760	19.1	0.22	0.10	3.5	88.9	350	24.1	HY	300
7132-50354	1/2	12.7	4	0.937	23.8	0.32	0.15	4.5	114.3	350	24.1	7661	500
7132-75354	3/4	19.1	4	1.250	31.8	0.50	0.23	6.5	165.1	350	24.1	HY	350
7132-75354100	3/4	19.1	4	1.250	31.8	0.50	0.23	6.5	165.1	350	24.1	HY	2 x 100
7132-75354125	3/4	19.1	4	1.250	31.8	0.50	0.23	6.5	165.1	350	24.1	HY	1 x 125
7132-75354150	3/4	19.1	4	1.250	31.8	0.50	0.23	6.5	165.1	350	24.1	HY	1 x 150
7132-75354200	3/4	19.1	4	1.250	31.8	0.50	0.23	6.5	165.1	350	24.1	HY	1 x 200
7132-100354	1	25.4	4	1.500	38.1	0.63	0.29	7.5	190.5	350	24.1	7661	300
7132-100354100	1	25.4	4	1.500	38.1	0.63	0.29	7.5	190.5	350	24.1	7661	100
7132-100354125	1	25.4	4	1.500	38.1	0.63	0.29	7.5	190.5	350	24.1	7661	1 x 125
7132-100354150	1	25.4	4	1.500	38.1	0.63	0.29	7.5	190.5	350	24.1	7661	1 x 150
7132-100354200	1	25.4	4	1.500	38.1	0.63	0.29	7.5	190.5	350	24.1	7661	200



# LPG Hose & Fitting

## LP Gas Hose UL21, CGA Type I Series 7132



## LP Gas Hose – Factory Assemblies UL21 / CGA Type I Series 7132

Crimped-on Carbon Steel Couplings, Rigid Male NPT Thread x Rigid Male NPT Thread  
Cartons



Factory assemblies (3/4" and larger) are Department of Transportation (DOT) pressure-tested, one of the fittings is etched with a unique DOT certification number, and a document incorporating the identical certification number accompanies each assembly. Metal DOT identification bands are also available/attached at an additional charge per customer request. Contact Parker.

Part Number	ID (in)	ID (mm)	Length (ft)	Length (mtrs)	Approx Wt (lbs/ea)	Approx Wt (kg/ea)	Std Pack Qty (ea)
7132TY08MP-72	1/2	12.7	6	1.83	2.53	1.15	1
7132TY08MP-96	1/2	12.7	8	2.44	3.17	1.44	10
7132TY08MP-120	1/2	12.7	10	3.05	3.82	1.73	10
7132TY08MP-144	1/2	12.7	12	3.66	4.46	2.02	10
7132TY08MP-180	1/2	12.7	15	4.57	5.42	2.46	10
7132TY08MP-216	1/2	12.7	18	5.49	6.39	2.90	10
7132TY08MP-240	1/2	12.7	20	6.10	7.03	3.19	10
7132TY08MP-300	1/2	12.7	25	7.62	8.64	3.92	10
7132TY08MP-600	1/2	12.7	50	15.24	16.68	7.57	10
7132TY08MP-1200	1/2	12.7	100	30.48	32.75	14.86	1
7132HY12MP-12	3/4	19.1	1	0.30	1.31	0.59	1
7132HY12MP-36	3/4	19.1	3	0.91	2.34	1.06	8
7132HY12MP-120	3/4	19.1	10	3.05	5.92	2.69	8
7132HY12MP-144	3/4	19.1	12	3.66	6.95	3.15	10
7132HY12MP-180	3/4	19.1	15	4.57	8.48	3.85	10
7132HY12MP-216	3/4	19.1	18	5.49	10.02	4.55	1
7132HY12MP-300	3/4	19.1	25	7.62	13.61	6.17	1
7132HY12MP-1200	3/4	19.1	100	30.48	52.03	23.60	1
7132HY12MP-1500	3/4	19.1	125	38.10	64.84	29.41	1
7132HY12MP-1800	3/4	19.1	150	45.70	77.65	35.22	1
7132LAR16MP-1200	1	25.4	100	30.48	65.06	29.51	1
7132LAR16MP-1500	1	25.4	125	38.10	80.98	36.73	1
7132LAR16MP-1800	1	25.4	150	45.70	96.90	43.95	1
7132LAR16MP-2100	1	25.4	175	53.34	112.81	51.17	1

# LPG Hose & Fitting

## LP Gas Hose UL21, CGA Type I Series 7232



Series 7232 is a large diameter, flexible liquefied petroleum gas (LPG)/propane transfer hose for large volume bulk loading/unloading and vibration-resistant onboard vehicle connections. The hose meets all Underwriters Laboratories (UL21) and Canadian Gas Association (CGA Type I) requirements. The construction incorporates multiple braids of textile reinforcement for kink resistance and superior coupling retention. The perforated cover is resistant to mild chemicals, oil and ozone. Series 7232 is available in long lengths and factory-tested assemblies in popular configurations.

**NOTE:** Refer to the Safety and Technical section of this catalog for safety, handling and use information.

**Series 7232 and DOT:** LPG hose assemblies installed on on-road vehicles must meet Department of Transportation (DOT) requirements. Factory assemblies (all sizes) are pressure tested, one of the fittings is etched with a unique DOT certification number, and a document incorporating the identical certification number accompanies each assembly. Metal DOT identification bands are also available/attached for an additional charge at customer request. Contact Parker.

**Series 7232 and Natural Gas:** The molecules of natural gas are small, enhancing their ability to permeate through standard rubber hose constructions. The permeation process is more rapid as the working pressure increases, and natural gas accumulates with potentially dangerous consequences. Series 7232 may be used for natural gas service, but ONLY under ALL of the following conditions:

- The application must be in a well-ventilated environment: Outdoors, or indoors with significant continuous air movement.
- Series 7232 is not to replace fixed/rigid pipe where that material is more appropriate due to reduced permeation and overall strength and durability. Use rigid pipe, non-permeable tubing or hose with barrier constructions to convey natural gas whenever possible.

**Series 7232 and Compressed Natural Gas (CNG):** Series 7232 is not to be used for any CNG application, including fuel dispensing, on-board vehicle fuel lines, or fuel transfer.

**Series 7232 and Anhydrous Ammonia (NH<sub>3</sub>):** Series 7232 is not for use with anhydrous ammonia.

**Tube:** Black nitrile  
**Reinforcement:** Multiple textile braids  
**Cover:** Black chloroprene; perforated wrapped finish  
**Temp. Range:** -40°F to +180°F (-40°C to +82°C) (The hose construction is capable of this rating, but LP Gas should NEVER be conveyed over 140°F/60°C)  
**Brand Method:** Side one: Embossed  
 Side two: Black text on yellow stripe  
**Brand Example:** Side one (Embossed): PARKER SERIES 7232 CGA TYPE I CAUTION - LP GAS HOSE MH6737 C UR® US ISSUE NO. XXXX 350 PSI MAX WP MADE IN USA (DATE CODE)  
 Side two (Stripe): PARKER LP GAS HOSE

**Design Factor:** 5:1  
**Industry Standards:** UL21; CAN/CGA-8.1-M86 Type I; optional DOT factory hose assembly testing and marking available. Contact Parker.

**Applications:**

- LP gas/propane
- Bulk loading/unloading, in-plant tank transfer, transport
- Agriculture, commercial and residential heating, construction, general industrial

**Vacuum:** Not recommended  
**Compare to:** Boston Blackline (LPG); Gates LP350; Thermoid Type 65  
**Packaging:** Cartons, reels

(Continued on the following page)

## Series 7232 – LP Gas Hose, UL21, CSA Type I (Continued)

Part Number	ID (in)	ID (mm)	Reinf Braids	OD (in)	OD (mm)	Approx Wt (lbs/ft)	Approx Wt (kg/ft)	Min Bend Rad (in)	Min Bend Rad (mm)	Max Rec WP (psi)	Max Rec WP (bar)	Perm Cplg Rec *	Std Pack Qty (ft)
7232-1252	1-1/4	31.8	2	1.815	46.1	0.85	0.39	12.0	304.8	350	24.1	HY	300
7232-1252100	1-1/4	31.8	2	1.815	46.1	0.85	0.39	12.0	304.8	350	24.1	HY	100
7232-1503K	1-1/2	38.1	2	2.156	54.8	1.12	0.51	14.0	355.6	350	24.1	43	150
7232-2003K	2	50.8	3	2.750	69.9	1.90	0.90	16.0	406.4	350	24.1	7661	150

## LP Gas Hose – Factory Assemblies UL21/CGA Type I Series 7232



Crimped on Carbon Steel Couplings, Rigid Male NPT Thread x Rigid Male NPT Thread  
Cartons

Factory assemblies (all sizes) are Department of Transportation (DOT) pressure-tested, one of the fittings is etched with a unique DOT certification number, and a document incorporating the identical certification number accompanies each assembly. Metal DOT identification bands are also available/attached at an additional charge per customer request. Contact Parker.

Part Number	ID (in)	ID (mm)	Length (ft)	Length (mtrs)	Approx Wt (lbs/ea)	Approx Wt (kg/ea)	Std Pack Qty (ea)
7232HY20MP-180	1-1/4	31.8	15	4.57	14.95	6.78	1
7232LA32NP-144	2	50.8	12	3.66	27.84	12.63	1
7232LA32NP-180	2	50.8	15	4.57	33.15	15.04	1
7232LA32NP-228	2	50.8	19	5.79	40.23	18.25	1



# LPG Hose & Fitting

## LP Gas Hose Stainless Steel Reinforced UL21, CGA Type I Series 7231



Series 7231 is a large diameter, extremely durable liquefied petroleum gas (LPG)/propane transfer hose for bulk loading/unloading and vibration-resistant onboard vehicle connections. The hose meets all Underwriters Laboratories (UL21) requirements and Canadian Gas Association (CGA Type I) requirements. The construction incorporates high tensile corrosion resistant stainless steel braided reinforcement for superior strength, durability and kink resistance. The perforated cover is resistant to mild chemicals, oil and ozone. Series 7231 is available in long lengths and factory-tested assemblies in popular configurations.

**NOTE:** Refer to the Safety and Technical section of this catalog for safety, handling and use information.

**Series 7231 and DOT:** LPG hose assemblies installed on on-road vehicles must meet Department of Transportation (DOT) requirements. Factory assemblies (all sizes) are pressure tested, one of the fittings is etched with a unique DOT certification number, and a document incorporating the identical certification number accompanies each assembly. Metal DOT identification bands are also available/attached for an additional charge at customer request. Contact Parker.

**Series 7231 and Natural Gas:** The molecules of natural gas are small, enhancing their ability to permeate through standard rubber hose constructions. The permeation process is more rapid as the working pressure increases, and natural gas accumulates with potentially dangerous consequences. Series 7231 may be used for natural gas service, but ONLY under ALL of the following conditions:

- The application must be in a well-ventilated environment: Outdoors, or indoors with significant continuous air movement.
- Series 7231 is not to replace fixed/rigid pipe where that material is more appropriate due to reduced permeation and overall strength and durability. Use rigid pipe, non-permeable tubing or hose with barrier constructions to convey natural gas whenever possible.

**Series 7231 and Compressed Natural Gas (CNG):** Series 7231 is not to be used for any CNG application, including fuel dispensing, on-board vehicle fuel lines, or fuel transfer.

**Series 7231 and Anhydrous Ammonia (NH<sub>3</sub>):** Series 7231 is not for use with anhydrous ammonia.

**Tube:** Black nitrile  
**Reinforcement:** One or multiple stainless steel braids  
**Cover:** Black chloroprene; perforated wrapped finish  
**Temp. Range:** -40°F to +180°F (-40°C to +82°C) (The hose construction is capable of this rating, but LP Gas should NEVER be conveyed over 140°F/60°C)  
**Brand Method:** Black text on blue stripe  
**Brand Example:** PARKER SERIES 7231 CGA TYPE I CAUTION - LP GAS HOSE MH6737 C UR® US ISSUE NO.XXXX 350 PSI MAX WP MADE IN USA (DATE CODE)  
**Design Factor:** 5:1  
**Industry Standards:** UL21; CAN/CGA-8.1-M86 Type I; optional DOT factory hose assembly testing and marking available. Contact Parker.  
**Applications:**

- LP gas/propane
- Bulk loading/unloading; in-plant tank transfer
- Petrochemical refineries

**Vacuum:** Not recommended  
**Packaging:** Cartons

(Continued on the following page)

### Series 7231 – LP Gas Hose, Stainless Steel Reinforced (Continued)

Part Number	ID (in)	ID (mm)	Reinf Braids	OD (in)	OD (mm)	Approx Wt (lbs/ft)	Approx Wt (kg/ft)	Min Bend Rad (in)	Min Bend Rad (mm)	Max Rec WP (psi)	Max Rec WP (bar)	Perm Cplg Rec *	Std Pack Qty (ft)
7231-1001	1	25.4	1	1.500	38.1	0.77	0.35	12.0	304.8	350	24.1	43	200
7231-1251	1-1/4	31.8	1	1.750	44.5	0.97	0.44	16.5	419.1	350	24.1	43	100
7231-1501K	1-1/2	38.1	1	2.000	50.8	1.12	0.51	20.0	508.0	350	24.1	43, 71	150
7231-2002K	2	50.8	2	2.625	66.7	1.87	0.85	25.5	635.0	350	24.1	WC, 43,	150
												71, 7661	



# LPG Hose & Fitting

## LP Gas Hose Static Wire ISO 2928-1986 (E) Series SS106



Series SS106 is a large diameter, heavy duty liquefied petroleum gas (LPG)/propane transfer hose for large volume bulk loading/unloading. The hose construction incorporates multiple plies of textile reinforcement for flexibility and kink resistance, and the perforated cover is resistant to abrasion, oil and ozone. The hose meets ISO 2928-1986 (E) requirements.

- NOTES:**
- Not for applications requiring Underwriters Laboratories (UL) or Canadian Gas Association (CGA) performance or listing.
  - Refer to the Safety and Technical section of this catalog for safety, handling and use information.

**Series SS106 and Natural Gas:** The molecules of natural gas are small, enhancing their ability to permeate through standard rubber hose constructions. The permeation process is more rapid as the working pressure increases, and natural gas accumulates with potentially dangerous consequences. Series SS106 may be used for natural gas service, but ONLY under ALL of the following conditions:

- The application must be in a well-ventilated environment: Outdoors, or indoors with significant continuous air movement.
- Series SS106 is not to replace fixed/rigid pipe where that material is more appropriate due to reduced permeation and overall strength and durability. Use rigid pipe, non-permeable tubing or hose with barrier constructions to convey natural gas whenever possible.

**Series SS106 and Compressed Natural Gas (CNG):** Series SS106 is not to be used for any CNG application, including fuel dispensing, on-board vehicle fuel lines, or fuel transfer.

**Series SS106 and Anhydrous Ammonia (NH<sub>3</sub>):** Series SS106 is not for use with anhydrous ammonia.

<b>Tube:</b>	Black nitrile
<b>Reinforcement:</b>	Multiple textile plies with static wire
<b>Cover:</b>	Black nitrile; perforated wrapped finish
<b>Temp. Range:</b>	-40°F to +180°F (-40°C to +82°C) (The hose construction is capable of this rating, but LP Gas should NEVER be conveyed over 140°F/60°C)
<b>Brand Method:</b>	Embossed
<b>Brand Example:</b>	PARKER SERIES SS106 (ID) LPG HOSE ISO 2928-1986 (E) 20 BAR 350 PSI WP (DATE CODE) MADE IN USA
<b>Design Factor:</b>	5:1
<b>Industry Standards:</b>	ISO 2928-1986 (E)
<b>Applications:</b>	<ul style="list-style-type: none"> <li>• LP gas/propane</li> <li>• Bulk loading/unloading; in-plant tank transfer</li> </ul>
<b>Vacuum:</b>	Not recommended
<b>Packaging:</b>	Coils

(Continued on the following page)

## Series SS106 – LP Gas Hose, Static Wire (Continued)

Part Number	ID (in)	ID (mm)	Reinf Plies	OD (in)	OD (mm)	Approx Wt (lbs/ft)	Approx Wt (kg/ft)	Max Rec WP (psi)	Max Rec WP (bar)	Perm Cplg Rec *	Std Pack Qty (ft)
SS106-1250	1-1/4	31.8	4	1.990	50.6	0.82	0.37	350	24.1	*	100
SS106-1500	1-1/2	38.1	4	2.240	56.9	0.98	0.44	350	24.1	*	100
SS106-2000	2	50.8	4	2.740	69.6	1.31	0.59	350	24.1	*	100
SS106-2500	2-1/2	63.5	4	3.240	82.3	1.87	0.85	350	24.1	*	100
SS106-3000	3	76.2	4	3.740	95.0	2.53	1.15	350	24.1	*	100
SS106-4000	4	101.6	6	5.000	127.0	4.47	2.03	350	24.1	*	100



# LPG Hose & Fitting

## Hose Fitting



King Crimp Style ANSI 150#,300#

Size : 2" ~6"

Material : Stainless Steel

# LPG Hose & Fitting

## Hose Fitting

### **Double Bolt Clamps** (Size : 1"~ 3")

#### Features:

- inner surface has dual gripping ridges
- bolt lugs are reinforced to prevent bending out of alignment
- Torque values for clamps are based on dry bolts.
- The use of lubricant on bolts will adversely effect clamp performance.
- measure hose OD accurately before ordering clamps



# LPG Hose & Fitting

## Hose Fitting

### **Double Bolt Clamps** (Size : 4"~ 15")

#### Features:

- inner surface has dual gripping ridges
- bolt lugs are reinforced to prevent bending out of alignment
- Torque values for clamps are based on dry bolts.
- The use of lubricant on bolts will adversely effect clamp performance.
- measure hose OD accurately before ordering clamps





# Steam Hose & Fitting



# Steam Hose & Fitting

## About Steam

- Steam is “Water gone wild with heat.”
- As energy (heat) is absorbed into water, it changes phase from liquid (water) to gas (steam).
- This occurs at 100°C (212°F) at atmospheric pressure.
- However, as pressure increases, the temperature at which this change occurs also increases.
- At 100 psi, water turns to steam at 170°C (338°F).

# Steam Hose & Fitting

## About Steam

- Steam at this transition point is called saturated steam. If additional energy (heat) is added and the temperature is increased, the steam becomes superheated.
- Steam is generally used in the saturated state, not the superheated state.
- Steam is used to transfer energy because it absorbs and gives up energy much faster than water.
- Typical plant operating pressures are 125-150 psi.(8.75-10.5Bar)

# Steam Hose & Fitting

## Steam Hose Chart

The chart below represents the three forms of water when subjected to heat and pressure. The red line represents the point at which hot water becomes saturated steam. The area above the line is superheated steam.

Gauge Pressure (PSI)	Temperature of Saturated Steam (°F)
0	212
10	239
25	267
50	298
75	320
100	338
125	353
150	366
175	377
200	388
225	397
250	406

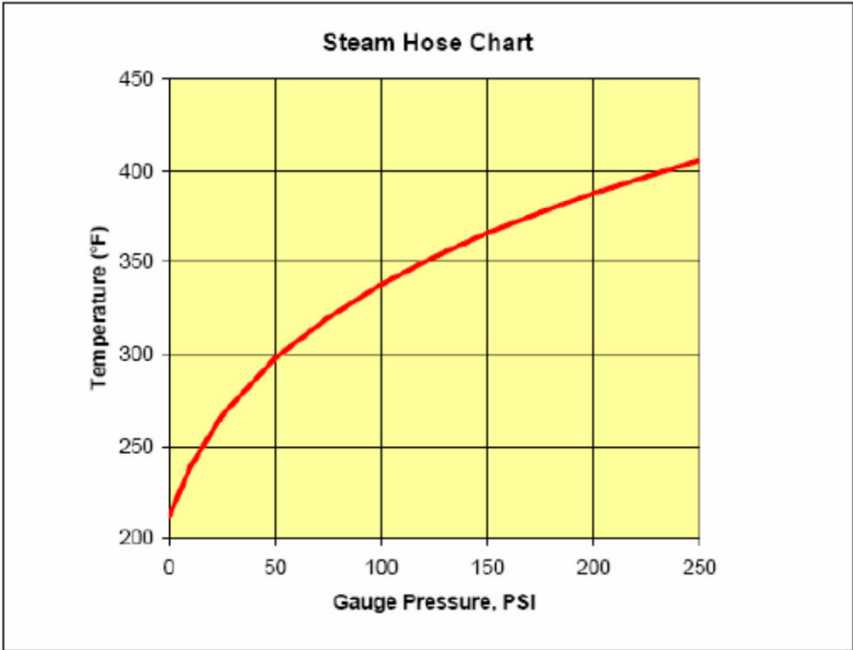

# Steam Hose & Fitting

## About Steam

- Because steam is a compressed gas at high temperatures, it is extremely dangerous.
- Steam hoses are designed with a 10:1 working pressure to burst ratio. Most hoses are 4:1.
- Steam permeates rubber hose. Because of this, the cover of steam hoses are perforated.
- Steam often has additives to prevent corrosion and scaling in the system.

# Steam Hose & Fitting

## Steam Hose Misapplications

- Steam hose has a relatively short service life. It should be maintained and inspected on a daily basis.
- Oil resistant hose is often specified but not needed. Typically, oil resistant steam hose does not have the service life of a non-oil resistant hose.
- Steam hose generally fails from the outside in. Visual inspection is very important.
- Cycling hot and cold through a steam hose will often cause popcorning (small rubber chunk resembling popcorn kernels) in the ID of the hose.
- Incompatibility with a boiler additive may cause tube swell.

# Steam Hose & Fitting

## Hose Selector Guide – by application

Series	Trademark	Hose Application / Construction / Selector Guide		Tube	Cover	Size Range (in)	Pressure Range (psi)	Temp Range (°F)	Page No.
7200		Hot hydrocarbon drainage		Nitrile	Chloroprene	3/4 - 1	250	-20 / +300 / 350	320
7204	MPW-1000®	Low pressure service	Oil resistant tube, cover	Nitrile	Chloroprene	1/2 - 1	150	-20 / +368	318
7263	STEAM-LANCE®	Standard service, black		EPDM	EPDM	1/2 - 1-1/4	250	-20 / +406 / 450	314
7263C	STEAM-LANCE®	Standard service, black	Compact; non-skive crimp couplings	EPDM	EPDM	1/2 - 1	250	-20 / +406 / 450	312
7263E	STEAM-LANCE®	Standard service, black		EPDM	EPDM	1-1/2 - 2	250	-20 / +406 / 450	314
7264	STEAM-LANCE®	Standard service, red		EPDM	EPDM	1/2 - 1	250	-20 / +406 / 450	314
7264C	STEAM-LANCE®	Standard service, red	Compact; non-skive crimp couplings	EPDM	EPDM	1/2 - 1	250	-20 / +406 / 450	312
7285	DRAGON BREATH®	Premium tube, barber pole cover	Non-skive crimp couplings	Chlorobutyl	EPDM	1/2 - 1	250	-20 / +406 / 450	311
7286C	DRAGON BREATH®	Premium tube and cover	Compact; non-skive crimp couplings	Chlorobutyl	Chlorobutyl	1/2 - 1	250	-20 / +406 / 450	317
7288	DRAGON BREATH®	Standard service, red	Oil resistant cover	EPDM	Chloroprene	1/2 - 1	250	-20 / +406 / 450	316

# Steam Hose & Fitting



**7263 - Black**  
**7264 - Red**

- EPDM tube & Cover
- Two wire braids
- 250 psi all sizes
- Sizes 1/2" - 2"



**7286 - Black**  
**7287 - Red**

- Butyl tube & Cover
- Premium product
- Two wire braids
- 250 psi all sizes
- Sizes 1/2" - 2"



**7288 - Red**

- EPDM tube
- Oil resistant cover
- Two wire braids
- 250 psi all sizes
- Sizes 1/2" - 2"



# Steam Hose & Fitting

## STEAM-LANCE® 250 EPDM Compact Steam Hose Non-Skive E-Z Crimp

Series 7263C (Black) and Series 7264C (Red)



Series 7263C/7264C is a compact, slim profile hose for long-lasting steam service, one of the toughest applications for hose, where the hot-cold/wet-dry cycling attacks rubber compounds externally as well as internally. The hose construction incorporates an EPDM tube that resists heat and popcorning, and a wire braid reinforcement for crush-resistant durability, kink resistance and a path to conduct a static electrical charge to ground. The EPDM cover is resistant to abrasion, cracking, hardening and ozone; the red cover of 7264C provides color-coded identification. Series 7263C/7264C is qualified with Parker non-skive crimp couplings for easy and quick assembly fabrication as well as maintenance-free service.

<b>Tube:</b>	Black EPDM
<b>Reinforcement:</b>	Multiple wire braids
<b>Cover:</b>	Black or red EPDM; perforated wrapped finish
<b>Temp. Range:</b>	-20°F to +406°F saturated steam/+450°F superheated steam (-29°C to +208°C saturated steam/+232°C superheated steam)
<b>Brand Method:</b>	Embossed
<b>Brand Example:</b>	PARKER SERIES (7263C) (7264C) STEAM-LANCE® E-Z CRIMP 250 PSI MAX WP MADE IN USA (DATE CODE)
<b>Design Factor:</b>	10:1
<b>Industry Standards:</b>	None applicable
<b>Applications:</b>	<ul style="list-style-type: none"> <li>• Saturated and superheated steam</li> <li>• Cleaning containment vessels and manufacturing equipment; cleaning and heating process equipment</li> <li>• Manufacturing and processing plants, refineries</li> </ul>
<b>Vacuum:</b>	Not recommended
<b>Compare to:</b>	Boston Concord 250; Gates 205MB Steam King; Goodall N2576 Thermoflex; Thermoid Burstproof Regular; Veyance Flexsteel 250 Steam
<b>Packaging:</b>	Cartons

(Continued on the following page)

## Series 7263C (Black) and Series 7264C (Red) – STEAM-LANCE® 250 EPDM Compact Steam Hose (Continued)

### Series 7263C (Black) and Series 7264C (Red)

Part Number 7263C or 7264C	ID (in)	ID (mm)	Reinf Braids	OD (in)	OD (mm)	Approx Wt (lbs/ft)	Approx Wt (kg/ft)	Min Bend Rad (in)	Min Bend Rad (mm)	Max Rec WP (psi)	Max Rec WP (bar)	Perm Cplg Rec *	Std Pack Qty (ft)
-502	1/2	12.7	2	0.950	24.1	0.37	0.17	7.0	177.8	250	17.2	71	50
-752	3/4	19.1	2	1.200	30.5	0.47	0.21	9.0	228.6	250	17.2	CS	50
-1002	1	25.4	2	1.467	37.3	0.63	0.29	12.0	304.8	250	17.2	CS	50



# Steam Hose & Fitting

## DRAGON BREATH® Chlorobutyl Compact Steam Hose Non-Skive E-Z Crimp Series 7286C



Series 7286C is a compact, slim profile hose designed for long-lasting steam service—one of the toughest applications for hose, where the hot-cold/wet-dry cycling attacks rubber compounds externally as well as internally. The hose construction incorporates premium, high-performance chlorobutyl in both the tube and the cover, providing extreme heat resistance, durability, performance and service life. The wire braid reinforcement provides crush-resistant durability, kink resistance and a path to conduct a static electrical charge to ground, and the cover resists abrasion, cracking, hardening and ozone. Series 7286C is qualified with Parker non-skive crimp couplings for easy and quick assembly fabrication as well as maintenance-free service.

<b>Tube:</b>	Black chlorobutyl
<b>Reinforcement:</b>	Multiple wire braids
<b>Cover:</b>	Black chlorobutyl; perforated wrapped finish
<b>Temp. Range:</b>	-20°F to +406°F saturated steam/+450°F superheated steam (-29°C to +208°C saturated steam/+232°C superheated steam)
<b>Brand Method:</b>	Embossed
<b>Brand Example:</b>	PARKER SERIES 7286C DRAGON BREATH® E-Z CRIMP BUTYL STEAM 250 PSI MAX WP MADE IN USA (DATE CODE)
<b>Design Factor:</b>	10:1
<b>Industry Standards:</b>	None applicable
<b>Applications:</b>	<ul style="list-style-type: none"> <li>• Saturated and superheated steam</li> <li>• Cleaning containment vessels and manufacturing equipment; cleaning and heating process equipment</li> <li>• Manufacturing and processing plants, refineries</li> </ul>
<b>Vacuum:</b>	Not recommended
<b>Packaging:</b>	Cartons

Part Number	ID (in)	ID (mm)	Reinf Braids	OD (in)	OD (mm)	Approx Wt (lbs/ft)	Approx Wt (kg/ft)	Min Bend Rad (in)	Min Bend Rad (mm)	Max Rec WP (psi)	Max Rec WP (bar)	Perm Cplg Rec *	Std Pack Qty (ft)
7286C-502	1/2	12.7	2	0.950	24.1	0.37	0.17	7.0	177.8	250	17.2	71	50
7286C-752	3/4	19.1	2	1.200	30.5	0.47	0.21	9.5	241.3	250	17.2	CS	50
7286C-1002	1	25.4	2	1.467	37.3	0.64	0.29	12.0	304.8	250	17.2	CS	50



# Steam Hose & Fitting

## DRAGON BREATH® 250 Oil Resistant Steam Hose Series 7288



Series 7288 is a traditional oil resistant hose designed for long-lasting steam service, one of the toughest applications for hose, where the hot/cold wet/dry cycling attacks rubber compounds externally as well as internally. The hose construction incorporates an EPDM tube that resists heat and popping, and a wire braid reinforcement for crush-resistant durability, kink resistance and a path to conduct a static electrical charge to ground. The red chloroprene cover is resistant to weathering and oil—an important criteria for oil refineries and petrochemical plants—and provides color-coded identification.

- Tube:** Black EPDM  
**Reinforcement:** Multiple wire braids  
**Cover:** ARPM Class B oil resistant red chloroprene; perforated wrapped finish  
**Temp. Range:** -20°F to +406°F saturated steam/+450°F superheated steam (-29°C to +208°C saturated steam/+232°C superheated steam)  
**Brand Method:** Embossed  
**Brand Example:** PARKER SERIES 7288 DRAGON BREATH® STEAM HOSE 250 PSI MAX WP OIL RESISTANT MADE IN USA (DATE CODE)  
**Design Factor:** 10:1  
**Industry Standards:** ARPM Class B oil resistant cover  
**Applications:**
  - Saturated and superheated steam
  - Cleaning containment vessels and manufacturing equipment; cleaning and heating process equipment
  - Manufacturing and processing plants, refineries**Vacuum:** Not recommended  
**Compare to:** Boston Concord 250 OR; Gates 232MB Steam Queen; Thermoid Burstproof Oil Resistant; Veyance Flexsteel 250 ORS  
**Packaging:** Cartons; Reels

Part Number	ID (in)	ID (mm)	Reinf Braids	OD (in)	OD (mm)	Approx Wt (lbs/ft)	Approx Wt (kg/ft)	Min Bend Rad (in)	Min Bend Rad (mm)	Max Rec WP (psi)	Max Rec WP (bar)	Perm Cplg Rec *	Std Pack Qty (ft)
7288-502	1/2	12.7	2	1.031	26.2	0.52	0.24	7.0	177.8	250	17.2	43	50
7288-502A	1/2	12.7	2	1.031	26.2	0.52	0.24	7.0	177.8	250	17.2	43	500
7288-752	3/4	19.1	2	1.343	34.1	0.73	0.33	9.5	241.3	250	17.2	CS, 43	50
7288-752A	3/4	19.1	2	1.343	34.1	0.73	0.33	9.5	241.3	250	17.2	CS, 43	500
7288-1002	1	25.4	2	1.594	40.5	0.90	0.41	12.0	304.8	250	17.2	CS, 43	50
7288-1002A	1	25.4	2	1.594	40.5	0.90	0.41	12.0	304.8	250	17.2	CS, 43	500

# Steam Hose & Fitting

## Hose Fitting

### Boss™ Coupling System

**Features:** The spud part of the coupling serves as one half of the connection and is usually fixed to the equipment. The stem part that is clamped to the hose is the other half. The two halves are connected or disconnected by rotating the wing nut onto the spud. When connected they achieve both a mechanical, and a pressure seal.

**Services:** Boss™ couplings are all-purpose hose couplings, universally recommended for steam hose connections. They are also widely used for air, water, fluid petroleum, chemicals and liquid petroleum gas up to 1" ID. Boss™ couplings can be applied to many types of rubber, synthetic, plastic, metallic or semi-metallic hose. Consult Dixon™ for specific media capabilities.

**Purpose:** Boss™ couplings supply a convenient threaded fitting to connect two lengths of hose, or a single length to a male or female threaded (NPT) outlet.

**Material:**

- stem: 1/4" - 1" plated steel, 1 1/4" - 4" plated iron, 6" tubular steel
- spud: 1/4" - 1" plated steel, 1 1/4" - 6" plated iron
- wing nut: 1/4" plated steel, 3/4" - 6" plated iron

**Seal Types:**

- ground joint: copper or polymer seats
- washer: Klingersil® C-4401

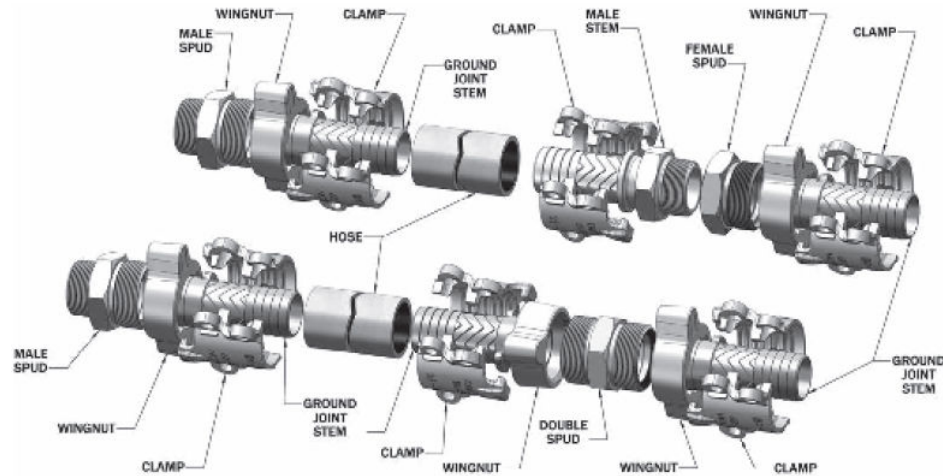

# Steam Hose & Fitting

## Hose Fitting



### GJ Boss™ Female Ground Joint Fittings

- available in plated steel and/or iron
- sizes 1/4" through 6"



### Boss™ Female Washer Seal Fittings

- available in plated steel and/or iron
- sizes 3/8" through 3"



### Boss™ Male Stems

- available in steel bar stock sizes 1/4" through 1"; iron in sizes 1 1/4" through 4"; 316 stainless steel in sizes 1/2" through 4" and brass in sizes 3/4" through 3"



### Boss™ Clamps

- 2-bolt and 4-bolt style available in plated iron in sizes 1/4" through 3"; stainless steel in sizes 1/2" through 3" and brass in sizes 1/2" through 2"
- three-piece style are available in plated iron in sizes 3" through 6"

# Steam Hose & Fitting

## Hose Fitting

### Boss Ground Joints & Washer Seal

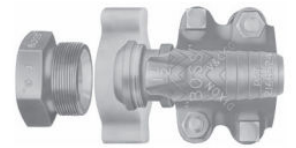

Boss Ground Joint



Boss Washer Seal

- Application:**
- hose couplings used in the transfer of steam, air, water and other petrochemical fluids
- Features:**
- A leakproof seal is formed when the metal head of the stem makes contact with the polymer seat in the spud.
  - The non-metallic polymer seat resists most chemicals found in manufacturing facilities.
  - easy to seal
  - Klingersil® C-4401 washer is inserted between the stem and spud
  - recommended for steam service up to 450°F (232°C)

- Materials:**
- plated steel, brass, stainless steel

- Sizes:**
- 1/4" - 6"



complete female      stem      wing nut      knurled nut      washer



female spud      male spud      double spud



***Thank You!***